

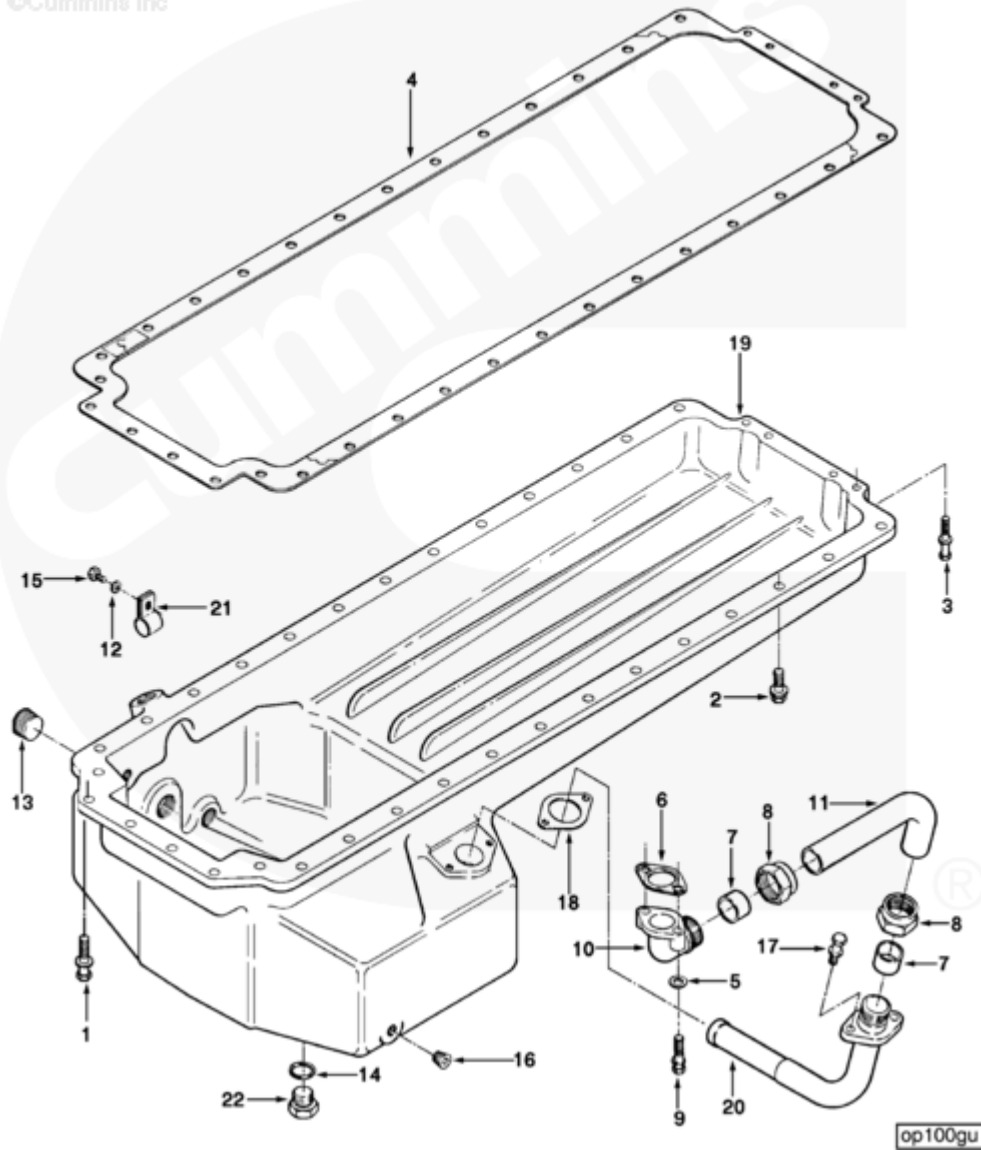

Parts Catalog - Option Detail

Electronic Parts Catalog - Option Detail				
Option	Group	Graphic	Film Card	Date
OP1394	07.01	op100gu	F	19-APR-94
Engines	NH/NT 855, NT495, NT743, NTA855 N106			

©Cummins Inc



[SMALL](#) | [MEDIUM](#) | [LARGE](#)

Cart	Ref No	Part Number	Part Description	Required	Remarks
<input type="button" value="View My Cart"/>					
		OP1394	Oil Pan		
					Oil Pan

					Aluminum 9 gallon capacity
					front sump oil pan.
					Angularity limits are
					45 degrees front down and
					45 degrees front up and
					45 degrees side to side.
<input type="checkbox"/>	1	3017049	Captive Washer Cap Screw	4	7/16 - 14 x 2 1/8 inch
<input type="checkbox"/>	2	3008069	Captive Washer Cap Screw	28	7/16 - 20 X 1 3/8 in.
<input type="checkbox"/>	3	3017050	Captive Washer Cap Screw	4	5/16 - 24 X 2 1/8 in.
<input type="checkbox"/>	4	3068463	Oil Pan Gasket	1	
		3032785	Tube , Lubrication Oil Suction	1	
<input type="checkbox"/>	5	S 602	Plain Washer	2	3/8 in.
<input type="checkbox"/>	6	157551	Oil Suction Connection Gasket	1	
<input type="checkbox"/>	7	197230	Grommet Seal	2	
<input type="checkbox"/>	8	3008795	Tube Nut	2	
<input type="checkbox"/>	9	3012473	Captive Washer Cap Screw	2	3/8 - 16 x 1 3/4 in.
<input type="checkbox"/>	10	3012527	Oil Suction Connection	1	
<input type="checkbox"/>	11	3029911	Lubricating Oil Transfer Tube	1	
<input type="checkbox"/>	12	S 631	Plain Washer	1	1/4 inch
<input type="checkbox"/>	13	S 907 A	Pipe Plug	1	1 1/4 NPT
<input type="checkbox"/>	14	67946	Plain Washer	2	1 1/32 in.
<input type="checkbox"/>	15	205409	Hexagon Head Cap Screw	1	1/4 - 20 x 5/8 inch
<input type="checkbox"/>	16	3008468	Pipe Plug	3	1/2 NPT.
<input type="checkbox"/>	17	3010596	Captive Washer Cap Screw	2	3/8 - 16 x 1 1/4 in.
<input type="checkbox"/>	18	3037421	Flange Gasket	1	
<input type="checkbox"/>	19	3040108	Oil Pan	1	
<input type="checkbox"/>	20	3040109	Lubricating Oil Suction Tube	1	
<input type="checkbox"/>	21	3041617	Clip	1	1 1/16 inch

	22	3055069	Threaded Plug	2	1 - 18 UNS.
--	----	-------------------------	---------------	---	-------------

© 2019 Cummins Inc., Box 3005, Columbus, IN 47202-3005 U.S.A.
Terms of Use and Disclaimers | Recommended System Requirements
Need Assistance? Please click on the Contact Us button in the top right corner of any page.